

NEW ROCKFORD CANAL PUBLIC HAY AUCTION
JUNE 10, 2025 - 3 P.M. CENTRAL TIME
at the
GDCD Operation and Maintenance Office
205 3rd Street SE, New Rockford, ND

If you are attending the hay auction, please bring this with you.

These parcels of land are being hayed to remove litter, stimulate new grass growth and assist with Garrison Diversion Conservancy District's (Garrison Diversion) weed control program. The intent is to include these parcels into a haying rotation where each parcel is hayed for two successive seasons and rested for two. An annual public auction will be held through a competitive bidding process. The highest bidder for each tract will be issued a one-year Mow Permit for the current year.

There are 5 individual parcels to be bid and hayed separately. There are approximately 161.5 total acres total being offered for bid. Minimum field size is 11 acres, and the maximum field size is 53.5 acres.

If you have any questions on field boundaries, access to fields or removal of bales, please call the New Rockford office between 7am and 5pm at 947-2001 (office) or 302-0058 (cell).

SPECIFICATIONS FOR MOWING & HAYING

1. The areas to be mowed consist of mixed grasses (clover, alfalfa, crested wheat, etc.) and will vary in width and length.
2. The right-of-way or tract area subject to mowing includes any area accessible with farming equipment between the designated boundary markers and the right-of-way fence.
3. Garrison Diversion is not responsible for noxious weeds being distributed in hay, but will attempt to spray weed patches prior to haying. If you notice any wormwood or leafy spurge patches in these hay fields that don't appear to have been sprayed, you are encouraged to inform us so they can be sprayed.
4. No haying will be permitted **before July 15** or **after August 15**, and only **one** cutting will be allowed. If hay tracts are not mowed or mowed after August 15, you will not be allowed to participate in this hay program for the following three years.
5. The permittee shall clip, rake, and bale **all** portions of the field including weedy patches and old vegetation. The permittee is required to remove **all** bales from the field, including partial bales.
6. **Prior** to mowing, Garrison Diversion **may** accept an approved practice to manage vegetation litter as an alternative to raking. Types that **may be** accepted include: harrowing, lightly discing, using a dump rake, etc.
7. **The deadline for removing all bales is October 15.** If the bales are not removed by midnight of October 15, or if any other provisions are not met, you will not be allowed to participate in the public hay auction for three years. **Bales not removed by the stated date**

will become the property of Garrison Diversion and will be sold on a first come first serve basis.

8. Access to the tract area will be allowed only at gates or access points. No fence cutting will be permitted. Equipment temporarily stored on the right-of-way shall be located in such a manner as not to impair any operations by Garrison Diversion personnel or become a safety hazard to the public.
9. All work must be done during daylight hours.
10. The permittee is responsible for any damage to the property under the control of Garrison Diversion resulting from the mowing and haying operations.
11. **Safety:** The permittee shall comply with normal farm safety regulations pertaining to the operation of equipment. The permittee shall save and hold harmless Garrison Diversion, its officers, agents, employees, and members from all claims, suits, or actions of whatever nature resulting from or arising out of this contract.
12. **Littering:** The permittee shall be responsible to see that no littering (oil cans, cartons, etc.) occurs on the tract areas related to his/her mowing and/or haying operations.
13. **Fire:** The permittee shall take all reasonable precautions to prevent fires, the escape of fires, to suppress fires, and shall render all reasonable assistance in the suppression of fires.
14. Payment must be received prior to Garrison Diversion issuing the haying permits. Payment may be in the form of personal check, money order, bank draft, cashier's check or certified check payable to Garrison Diversion Conservancy District. A taxpayer ID or driver's license number is required.
15. The permittee is not allowed to **Sublease hay tract.**

Competitive bids will be on a per site basis.

The minimum bid is \$10 per site, with the minimum bidding raise set at \$50 per site.

Garrison Diversion reserves the right to withdraw any and all fields from the sale up until the haying date. In the event that this right is exercised, a full refund will be made on your payment for those fields.

The chemicals Milestone, 2,4-D amine, and Venue are used for weed control on the New Rockford Canal right-of-way. If you have any questions on the chemical used in 2024 on a specific hay tract, please call the New Rockford office for more information.

Note: These specifications are a part of your contract.

Failure to comply with all provisions of this agreement will make you ineligible to participate in the hay auctions for the next three years.

TRACT #	LOCATION	ACRES
NR 1 L&R	From beginning of canal to Hwy 52 Drop (bridge NR 1-3, 1-4)	50
NR 3 L&R	From Bridge NR 1-6 to Bridge NR 1-7	17
NR 5 L&R	From Drop Structure #2 to Drop Structure NR 1-11	53.5
NR 7 L&R	From Railroad Crossing NR 2-2a to Bridge NR 2-3	11
NR 9 L&R	From Bridge NR 2-6 to end of canal	30
Approximate Mowable Acres		161.5

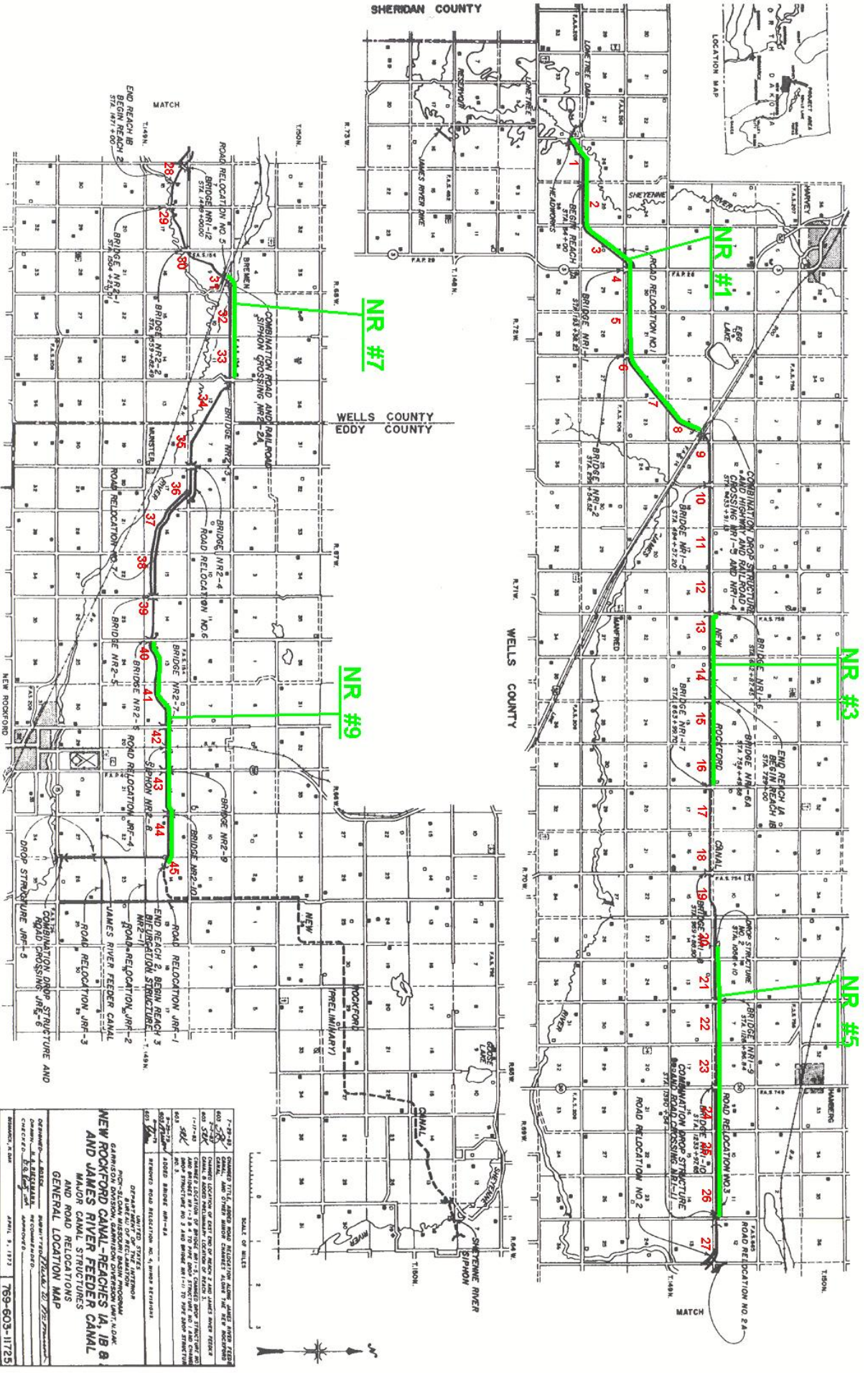

SHERIDAN COUNTY

NR #7

WELLS COUNTY
EDDY COUNTY

NR #9

NR #3

NR #5

7-1972 COMPLETED ROAD RELOCATION AND BRIDGE STRUCTURE
 8-1972 COMPLETED ROAD RELOCATION AND BRIDGE STRUCTURE
 9-1972 COMPLETED ROAD RELOCATION AND BRIDGE STRUCTURE
 10-1972 COMPLETED ROAD RELOCATION AND BRIDGE STRUCTURE
 11-1972 COMPLETED ROAD RELOCATION AND BRIDGE STRUCTURE
 12-1972 COMPLETED ROAD RELOCATION AND BRIDGE STRUCTURE
 13-1972 COMPLETED ROAD RELOCATION AND BRIDGE STRUCTURE
 14-1972 COMPLETED ROAD RELOCATION AND BRIDGE STRUCTURE
 15-1972 COMPLETED ROAD RELOCATION AND BRIDGE STRUCTURE
 16-1972 COMPLETED ROAD RELOCATION AND BRIDGE STRUCTURE
 17-1972 COMPLETED ROAD RELOCATION AND BRIDGE STRUCTURE
 18-1972 COMPLETED ROAD RELOCATION AND BRIDGE STRUCTURE
 19-1972 COMPLETED ROAD RELOCATION AND BRIDGE STRUCTURE
 20-1972 COMPLETED ROAD RELOCATION AND BRIDGE STRUCTURE
 21-1972 COMPLETED ROAD RELOCATION AND BRIDGE STRUCTURE
 22-1972 COMPLETED ROAD RELOCATION AND BRIDGE STRUCTURE
 23-1972 COMPLETED ROAD RELOCATION AND BRIDGE STRUCTURE
 24-1972 COMPLETED ROAD RELOCATION AND BRIDGE STRUCTURE
 25-1972 COMPLETED ROAD RELOCATION AND BRIDGE STRUCTURE
 26-1972 COMPLETED ROAD RELOCATION AND BRIDGE STRUCTURE
 27-1972 COMPLETED ROAD RELOCATION AND BRIDGE STRUCTURE
 28-1972 COMPLETED ROAD RELOCATION AND BRIDGE STRUCTURE
 29-1972 COMPLETED ROAD RELOCATION AND BRIDGE STRUCTURE
 30-1972 COMPLETED ROAD RELOCATION AND BRIDGE STRUCTURE
 31-1972 COMPLETED ROAD RELOCATION AND BRIDGE STRUCTURE
 32-1972 COMPLETED ROAD RELOCATION AND BRIDGE STRUCTURE
 33-1972 COMPLETED ROAD RELOCATION AND BRIDGE STRUCTURE
 34-1972 COMPLETED ROAD RELOCATION AND BRIDGE STRUCTURE
 35-1972 COMPLETED ROAD RELOCATION AND BRIDGE STRUCTURE
 36-1972 COMPLETED ROAD RELOCATION AND BRIDGE STRUCTURE
 37-1972 COMPLETED ROAD RELOCATION AND BRIDGE STRUCTURE
 38-1972 COMPLETED ROAD RELOCATION AND BRIDGE STRUCTURE
 39-1972 COMPLETED ROAD RELOCATION AND BRIDGE STRUCTURE
 40-1972 COMPLETED ROAD RELOCATION AND BRIDGE STRUCTURE
 41-1972 COMPLETED ROAD RELOCATION AND BRIDGE STRUCTURE
 42-1972 COMPLETED ROAD RELOCATION AND BRIDGE STRUCTURE
 43-1972 COMPLETED ROAD RELOCATION AND BRIDGE STRUCTURE
 44-1972 COMPLETED ROAD RELOCATION AND BRIDGE STRUCTURE
 45-1972 COMPLETED ROAD RELOCATION AND BRIDGE STRUCTURE

DEPARTMENT OF HIGHWAYS
 DIVISION OF STATE HIGHWAYS
 GANNON DIVISION, GANNON DIVISION UNIT 1, D.M.K.
 AND JAMES RIVER FEEDER CANAL
 MAJOR CANAL STRUCTURES
 AND ROAD RELOCATIONS
 GENERAL LOCATION MAP

DESIGNED BY: [Name]
 DRAWN BY: [Name]
 CHECKED BY: [Name]
 APPROVED BY: [Name]

APRIL 15, 1977 769-603-11725